

COMPACT. FAST. SECURE.



VEGA-RC TWIN

Reduce operational costs and keep customers happy with the amazing new, super compact Vega-RC Twin™ from JCM Global®! Vega-RC Twin has two large-capacity drums for 30 banknotes each for instant payout, keeping your equipment running and your customers happy. Plus, Vega-RC Twin has an improved security design which prevents notes in the RC unit from being accessed by service technicians.

FEATURES

- Two high-capacity recycling drums
- Improved security features
- Supports ccTalk and ID-003
- Compact body (only 20mm higher than single drum)
- Load banknotes into RC unit through bezel

BENEFITS

- Reduces float & risk of coin starvation
- Prevents technicians from accessing banknotes
- Assures easy integration to any machine in the field
- Easy retrofit from standard Vega-RC
- Fast and convenient loading



NUMBER OF RECYCLED DENOMINATIONS

- 2 denominations

RECYCLE CAPACITY

- 30 notes for each denomination

BANKNOTE SIZE

- Width: 60-82mm (2.36-3.23")
- Length: 110-160 mm (4.33-6.3")

POWER SUPPLY

- 12V / 24V

PROCESSING SPEED

- Accepting banknotes to RC: 3 seconds
- Accepting banknotes to cashbox: 3 seconds
- Pay out: 3 seconds

DIMENSIONS (HxWxD)

- 137x115.2x155.1mm (5.4x4.54x4.53")

WEIGHT

- 1.78kg (3.92 lbs) - Vega-RC Twin unit
- 3.78kg (8.33 lbs) - with Vega main unit (300 cashbox)

CASHBOX CAPACITY

- 300 notes (standard)
- 1,000 notes (optional)

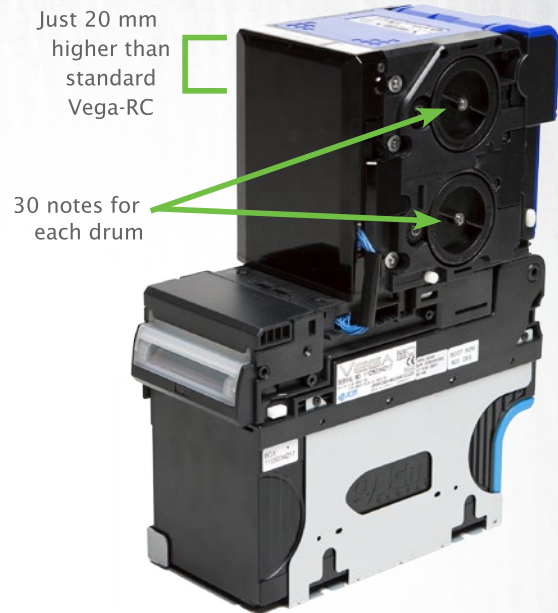

SECURITY FEATURES



Unit lock option



No access to banknotes when the rear cover is open

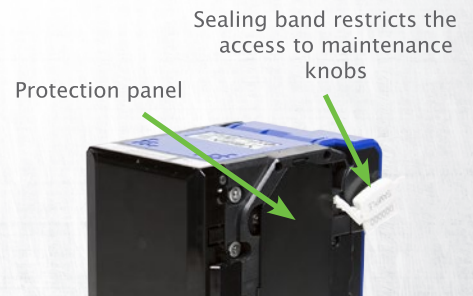

Protection panel

Sealing band restricts the access to maintenance knobs



AMERICAS: 1.702.651.0000 • AUSTRALASIA: 61.2.9648.0811 • EMEA: 49.211.5306.4550
JAPAN: 81.6.6703.8400 • MACAU: 853.2872.2684 • US: 1.800.683.7248

jcmglobal.com

JCM and JCM logo are registered trademarks of Japan Cash Machine Co., Ltd. and JCM American Corporation. All other marks are registered trademarks of their respective owners. JCM reserves the right to change product specifications without notice.