

www.jcmglobal.com

For updates on JCM Global products, services, and events, follow JCM Global on Facebook®, LinkedIn®, Twitter™ and YouTube™



facebook.com/JCMglobal

twitter.com/jcmglobal

linkedin.com/company/jcm-global

youtube.com/jcmglobal

Parts are Parts



Figure 1 iVIZION® Pusher Mechanism (P/N 197878)

Part No. 197878

Description: iVIZION® Pusher Mechanism

Usage: The iVIZION Cash Box's Pusher Mechanism (Figure 1) features stronger gears mounted flush to the surface and away from the edge to prevent damage. The Pusher Mechanism can be moved manually to verify the last accepted Banknote through the Cash Box's dispute windows. The Pusher Mechanism Transport Belt System's serpentine design has fewer contact points on the Banknote, allowing smoother transition into the Cash Box. The iVIZION Unit's Stacker Motor rotates in one direction only, accepting and stacking Banknotes in less than three (3) seconds note-to-note.

Note: The Pusher Mechanism can be removed for service, cleaning or replacement. To do so, remove two (2) screws and slide the Pusher Mechanism out of the Cash Box.

Latest JCM Software Listing

UNIT	Country	ID	Version	Check Sum	CRC
UBA-10/11-SS	USA	ID-003	V-2.78-51	D6F5	0653
UBA-10/11-SS	USA	ID-024	V-2.78-24	9478	0C33
UBA-14/24-SS/SU	USA	ID-003	V-2.78-39	C51D	9914
UBA-14/24-SS/SU	USA	ID-0G8	V-2.80-74	8062	8DD4
UBA-14/24-SS/SU	USA	ID-024	V-2.78-36	5CC9	9374
UBA-14/24-SS/SU	USA	ID-028	V-2.78-25	91A6	8F70
iVIZION-100 SS/SU	USA	ID-003	V-2.80-42	02A1	964D
iVIZION-100 SS/SU	USA	ID-008	V-2.83-22	7DEB	39B4
iVIZION-100 SS/SU	USA	ID-024	V-2.80-15	AA27	271B
iVIZION-100 SS/SU	USA	ID-028	V-2.80-30	1021	E2E1
iVIZION-100 SS/SU	USA	ID-0G8	V-2.80-38	1905	C088
UBA-10/11-SS	CAN	ID-003	V-2.82-52	B445	56DD
UBA-10/11-SS	CAN	ID-024	V-2.82-25	8FC3	D9AD
UBA-14/24-SS/SU	CAN	ID-003	V-2.82-40	CEF6	5E8C
UBA-14/24-SS/SU	CAN	ID-024	V-2.82-37	C66F	E2BE
UBA-14/24-SS/SU	CAN	ID-028	V-2.82-25	FD47	E01A
UBA-14/24-SS/SU	CAN	ID-0G8	V-2.82-74	F0D0	9716
iVIZION-100 SS/SU	CAN	ID-003	V-2.82-44	5B45	208A
iVIZION-100 SS/SU	CAN	ID-024	V-2.82-15	C6B6	8D4D
iVIZION-100 SS/SU	CAN	ID-028	V-2.82-30	C8BB	0AAA
iVIZION-100 SS/SU	CAN	ID-0G8	V-2.82-38	5784	92A2

The Latest JCM Software Listing (shown above) identifies specific software versions that have been released to OEMs. It is the responsibility of the OEM to obtain all required approvals from Gaming Regulators and Jurisdictional Authorities necessary for use of approved software versions. Contact the Game Manufacturer (OEM) for information on specific software releases approved for use within your gaming jurisdiction.

JCM recommends using the latest version for maximum acceptance, security, and performance.

JCM Service Offerings

JCM offers the following services to help keep your JCM Products performing within factory specifications:

- Warranty and Non-Warranty Service and Repair
- Custom Training Classes
- Unit Exchange Programs
- Preventive Maintenance Programs
- ICB Data Analysis
- Validator Performance Analysis

JCMedia™ Is The Source For All Your Video Needs!

JCMedia™ solutions incorporate the latest digital display technology (single screen to large scale video wall solutions), digital content creation services and networked solutions for all your media needs. JCMedia now offers the only upgradeable pixel pitch LED Displays using JCM's PIXELPRO™ Display Technology. PIXELPRO products combine unsurpassed color uniformity and the best pixel-to-pixel resolution available in the Gaming industry in an easy-to-install package. PIXELPRO MAX™ provides a high-resolution interlocking panel solution for large scale LED Video screens. PIXELPRO FLEX™ offers articulating panels for curved surface implementations, and PIXELPRO CUBE™ supports 3-D Video Displays. For more information, please visit the JCM Global website at jcmmedia.jcmglobal.com!





FREE REGIONAL TRAINING

Technicians need training, but is time or class availability a problem? JCM Online Training offers classes to meet your schedule and your needs. JCM Online Training Programs feature the same content as JCM On-site Training with the added convenience of flexible scheduling. Visit training.jcmglobal.com for more information or to register for classes.

Technical Bulletin 201810 September 2018

Technical Tip

Question: Is the 600 Ticket Tray Extension (Plastic) for the GEN5™ Printer available?

Answer: The 600 Ticket Tray Extension (Plastic) for the GEN5™ Printer (**Figure 2**) is available to ship.

The GEN5 Printer's 200 Ticket Capacity Standard paper tray can easily be upgraded using the 600 Ticket Tray Extension (P/N 370-00478-100). The 600 Ticket Tray Extension reduces downtime due to Paper Out conditions, resulting in more play time for customers.

The easy-to-install 600 Ticket Tray Extension fits onto the existing GEN5 Printer Paper Tray, and is secured using four (4) self-tapping screws provided with the 600 Ticket Tray Extension.

A metal 600 Ticket Tray Extension (P/N 320-00224-101) is also available (in limited supplies) from JCM. If greater paper capacity is needed, a metal 900 Ticket Tray Extension (P/N 320-00224-102) is also available.

For additional information on JCM Products, visit the JCM Global website at www.jcmglobal.com, or contact your local JCM Sales Representative at (800) 683-7248.

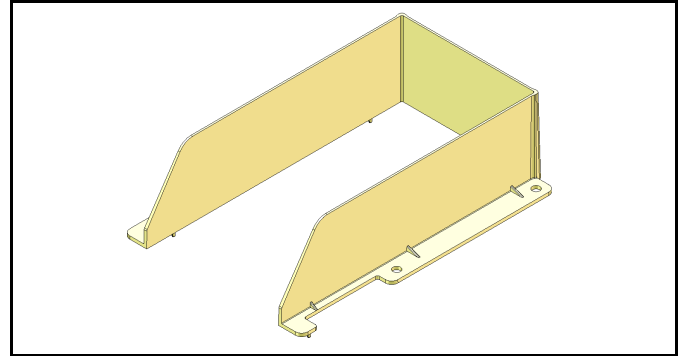

Figure 2 600 Ticket Tray Extension (GEN5™ Printer)

Current Service Manual Releases

Product	Rev.	Product	Rev.
DBV-30X	4	IVIZION	7
DBV-500 Operations Manual	1	Taiko (PUB-7/11)	6
DBV-400 Operations Manual	1	TBV	3
DT-200 BlueWave 2	7	TBV-101-ASH	A
EBA-40	2	UBA-10/11/14/24/25	3b
ICB Service Manual	4	UBA-RC	3
ICB 3.0 Web Reports Ops Manual	3	VEGA	4
iPRO	1	VEGA-RC	3
iPRO-RC	3	FL Operator & Technician's Manual	3
RC-10 Service Manual	1	GEN5 Operations Manual	2
JCM Tool Suite	4	BlueWaveDX Tool (DT-300)	1

To access JCM Product Manuals, please visit: www.jcmglobal.com



JCM TECHNICAL SUPPORT CONTACTS

Headquarters (Japan)

Sales and Service +81-3-5962-3731 hq-jp@jcmglobal.com

Europe, Middle East, Africa, Russia

Sales +49-211-530645-50
Service +49-211-530645-60 support@jcmglobal.eu

Australia, Oceania

Sales and Service +612 96 48 0811 australia@jcmglobal.com

Southeast Asia

Sales and Service +853 28 72 2684 asiassupport@jcmglobal.com

North/South America/Canada/Caribbean

Toll Free Product Support (800) 683-7248 or (702) 651-0000 support@jcmglobal.com

After Hours Americas Support

JCM American prides itself in offering the best Customer Service in the industry. We offer a 24 hour After Hours Hotline, where Technical Support Personnel can be reached at any time, 7 days a week. To reach our 24/7 After Hours Hotline:
1.) Call JCM American at (800) 683-7248.
2.) Select "Option 1" and wait for the call to be transferred to the JCM after hours Technical Support line.
3.) Speak with a certified JCM Support Technician about your situation.

JCM Global is a registered trademark of JCM American Corporation. All other product names mentioned herein may be registered trademarks or trademarks of their respective companies. Furthermore, TM and © are not mentioned in each case in this publication.